

## 로드셀 (Load Cell) 500g

4선식 Full Bridge, 500g Al Beam Load Cell

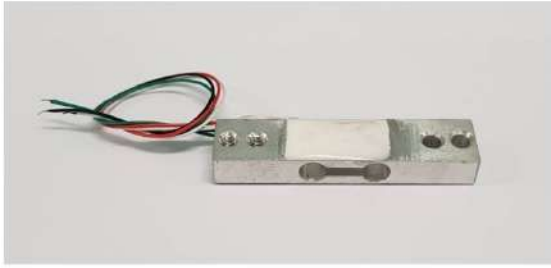

### ◆ Feature

- 측정방식 : Full-Bridge 방식
- 최대 측정범위 : 500g
- 최대 허용범위 : 750g
- 인가전압 : Max 8V
- Impedance : 1000+-50(ohm)
- 제품크기 : 45\*10\*6mm

### ◆ Application

- 가전제품
- 체중계
- 전자저울
- 산업장비

### ◆ Specification

|   |                     |                        |                   |
|---|---------------------|------------------------|-------------------|
| Input Resistance:                             | 1000 ± 50 Ω         | Output Resistance:     | 1000 ± 50 Ω       |
| Capacity:                                     | 500g                | Safety Overload :      | 120%F.S           |
| Max Overload:                                 | 150(%F.S)           | Hysteresis:            | ≦ 0.05(%F.S)      |
| Repeatability:                                | 0.05(%F.S)          | Non-linearity:         | ≦ 0.05(%F.S)      |
| Creeping:                                     | ≦ ± 0.05 (2min)%F.S | Temp.Effect On Zero:   | ≦ 0.3(%F.S/10℃)   |
| Output Sensitivity:                           | 0.7 ± 0.1mV/V       | Zero Drift:            | ≦ 0.05 (1min)%F.S |
| Zero Output:                                  | ± 0.1mV/V           | Storage Temp.          | -10℃ ~ +50℃       |
| Temp. Effect On Span                          | ≦ 0.2(%F.S/10℃)     | Insulation Resistance: | 2000MΩ/100VDC     |
| Power Supply:                                 | 5V                  | Max Power Supply:      | 8V                |
| Comprehensive Error:                          | 0.05%F.S            |                        |                   |
| Spring strain material: Aluminium alloy #2024 |                     |                        |                   |
| Sensor connection & dimensions:               |                     |                        |                   |
| Red wire                                      | Supply+             | Blue wire              | Signal+           |
| Black wire                                    | Supply-             | White wire             | Signal-           |
| Wire total length: 80mm                       |                     |                        |                   |
| Wire diameter: φ 0.6mm                        |                     |                        |                   |

### ◆ Dimension

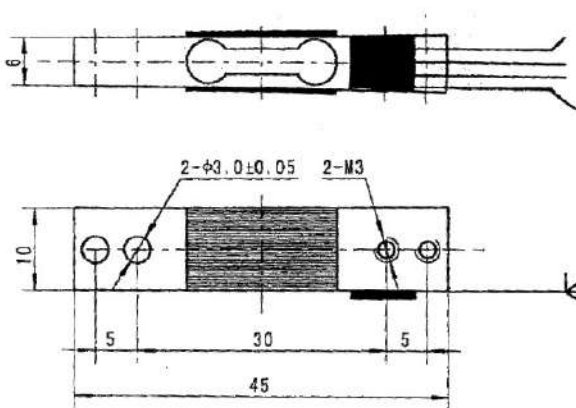

| Sensor connection & dimension: |            |
|--------------------------------|------------|
| Wire diameter:                 | 0.8mm      |
| Wire total length:             | 240mm      |
| S+ Signal +                    | blue wire  |
| S- Signal -                    | white wire |
| E+ Drive supply +              | red wire   |
| E- Drive supply -              | black wire |

## 로드셀 (Load Cell) 5Kg

4선식 Full Bridge, 5Kg Al Beam Load Cell

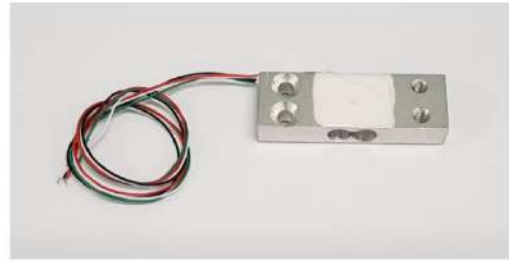

### ◆ Feature

- 측정방식 : Full-Bridge 방식
- 최대 측정범위 : 5Kg
- 최대 허용범위 : 7.5Kg
- 인가전압 : Max 8V
- Impedance : 1000+-10(ohm)

### ◆ Application

- 가전제품
- 체중계
- 전자저울
- 산업장비

### ◆ Specification

|    |                       |                |
|----|-----------------------|----------------|
| 1  | Capacity              | 5kg            |
| 2  | Input resistance      | 1000±10Ω       |
| 3  | Output resistance     | 1000±10Ω       |
| 4  | Safe load             | 120%F.S        |
| 5  | Hysteresis error      | 0.2% F.S       |
| 6  | Repeatability         | 0.2% F.S       |
| 7  | Non-linearity         | 0.3% F.S       |
| 8  | Creep                 | 0.2%F.S        |
| 9  | Zero thermo drift     | 0.2% (10℃)     |
| 10 | Sensitivity           | 0.5±0.1 (mV/V) |
| 11 | Zero shift            | 0.1%(2min)     |
| 12 | Zero output           | ±0.4mV/V       |
| 13 | Storage temperature   | -20℃~+50℃      |
| 14 | Output thermo effect  | 0.2%(10℃)      |
| 15 | Insulation resistance | 2000MΩ/100VDC  |
| 16 | Power supply          | 5V             |
| 17 | Max power supply      | 8V             |
| 18 | Comprehensive error   | 0.3% F.S       |
| 19 | Material              | 65Mn           |

### ◆ Dimension

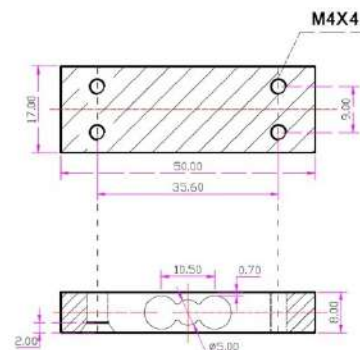

| Sensor connection & dimension: |            |
|--------------------------------|------------|
| Wire diameter:                 | 0.8mm      |
| Wire total length:             | 240mm      |
| S+ Signal +                    | blue wire  |
| S- Signal -                    | white wire |
| E+ Drive supply +              | red wire   |
| E- Drive supply -              | black wire |